

Linear Ball Bearings

Self - Aligning linear ball bearings (Inch)

Use with hardened precision - ground shafts made of steel, chrome - plated steel or stainless steel that have a hardness of at least rockwell C60. Closed bearings - Use with end - supported shafts. Open bearings - Use with continuously supported shafts (Also called shafts with support rail).

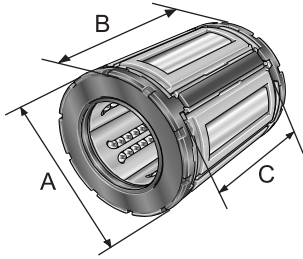

Close Bearing

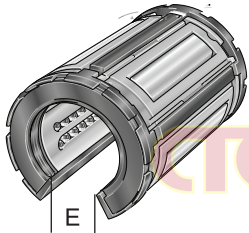

Open Bearing

Inch Sizes

Bearing ID (In.)	Dynamic Load Cap., lbs.	OD (A) (In.)	Housing Bore (In.)		O' all Lg. (B) (In.)	Groove Distance	Closed Bearings		Open Bearings		
			Min.	Max.			Number	Price ₱	Wd. (E) (In.)	Number	Price ₱
3/16"	35	3/8"	0.3750	0.3755	9/16"	—	6C89 0971	—	—	—	—
1/4"	39	1/2"	0.5000	0.5007	3/4"	0.515	6C89 0972	—	—	—	—
1/4"	60	1/2"	0.5000	0.5005	3/4"	0.511	6C89 0973	—	—	—	—
3/8"	59	5/8"	0.6250	0.6257	7/8"	0.703	6C89 0974	—	—	—	—
3/8"	100	5/8"	0.6250	0.6255	7/8"	0.699	6C89 0975	—	—	—	—
1/2"	260	7/8"	0.8750	0.8758	1 1/4"	1.032	6C89 0976	—	5/16"	8C74 4287	—
5/8"	290	1 1/8"	1.1250	1.1258	1 1/2"	1.112	6C89 0977	—	3/8"	8C74 4288	—
3/4"	430	1 1/4"	1.2500	1.2510	1 5/8"	1.272	6C89 0978	—	7/16"	8C74 4289	—
1"	810	1 9/16"	1.5625	1.5635	2 1/4"	1.886	6C89 0979	—	9/16"	8C74 4290	—
1 1/4"	1490	2"	2.0000	2.0012	2 5/8"	2.011	6C89 0980	—	5/8"	8C74 4291	—
1 1/2"	2090	2 3/8"	2.3750	2.3762	3"	2.422	6C89 0981	—	3/4"	8C74 4292	—
2"	3500	3"	3.0000	3.0012	4"	3.206	6C89 0982	—	1"	8C74 4293	—

Double Wide Type

Slide bush is a linear motion mechanism utilizing the rotational motion of ball elements. Since linear motion is obtained using a simple mechanism, the slide bush can be used in a wide variety of applications including transportation equipment, food processing equipment and semiconductor equipment.

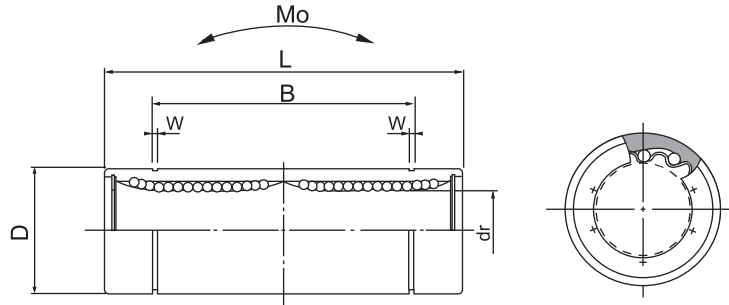

Standard				Anticorrosion				Number of Ball Circuits	Dimensions					Load Rating Static Co. N	Allowable Static Moment Mo N.m
Steel Retainer		Resin Retainer		Stainless Steel Retainer		Resin Retainer			dr (mm)	D (mm)	L (mm)	B (mm)	W (mm)		
Number	Price ₱	Number	Price ₱	Number	Price ₱	Number	Price ₱								
5P26 1850	—	5P26 1950	—	5P26 2050	—	5P26 2150	—	4	3	7	19	—	—	210	0.51
5P26 1851	—	5P26 1951	—	5P26 2051	—	5P26 2151	—	4	4	8	23	—	—	254	0.63
5P26 1852	—	5P26 1952	—	5P26 2052	—	5P26 2152	—	4	5	10	28	20.4	1.1	412	1.38
5P26 1853	—	5P26 1953	—	5P26 2053	—	5P26 2153	—	4	6	12	35	27	1.1	530	2.18
5P26 1854	—	5P26 1954	—	5P26 2054	—	5P26 2154	—	4	8	15	45	35	1.1	784	4.31
5P26 1855	—	5P26 1955	—	5P26 2055	—	5P26 2155	—	4	10	19	55	44	1.3	1,100	7.24
5P26 1856	—	5P26 1956	—	5P26 2056	—	5P26 2156	—	4	12	21	57	46	1.3	1,570	10.9
5P26 1857	—	5P26 1957	—	5P26 2057	—	5P26 2157	—	4	13	23	61	46	1.3	1,570	11.6
5P26 1858	—	5P26 1958	—	5P26 2058	—	5P26 2158	—	4	16	28	70	53	1.6	2,350	19.7
5P26 1859	—	5P26 1959	—	5P26 2059	—	5P26 2159	—	5	20	32	80	61	1.6	2,740	26.8
5P26 1860	—	5P26 1960	—	5P26 2060	—	5P26 2160	—	6	25	40	112	82	1.85	3,140	43.4
5P26 1861	—	5P26 1961	—	5P26 2061	—	5P26 2161	—	6	30	45	123	89	1.85	5,490	82.8
5P26 1862	—	5P26 1962	—	5P26 2062	—	5P26 2162	—	6	35	52	135	99	2.1	6,270	110
5P26 1863	—	5P26 1963	—	5P26 2063	—	5P26 2163	—	6	40	60	151	121	2.1	8,040	147
5P26 1864	—	5P26 1964	—	5P26 2064	—	5P26 2164	—	6	50	80	192	148	2.6	15,900	397
5P26 1865	—	5P26 1965	—	5P26 2065	—	5P26 2165	—	6	60	90	209	170	3.15	20,000	530